

## Mobile Device Management Enrollment Guide – iOS

This is the procedure for enrolling iOS devices to Intune. If your device is already enrolled in another mobile device management system (such as MobileIron, MaaS365, Jamf), you should de-provision it first.

iOS Enrollment Intune

The first step is to download the Intune Company portal from Apple App Store:

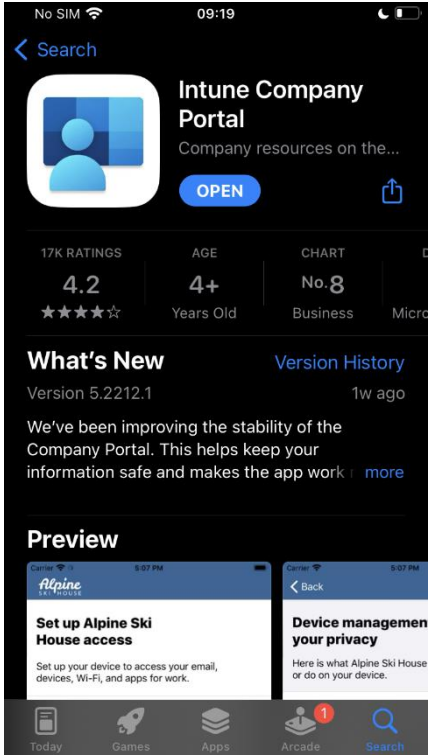

When installed, start the company portal app and start the sign-in process

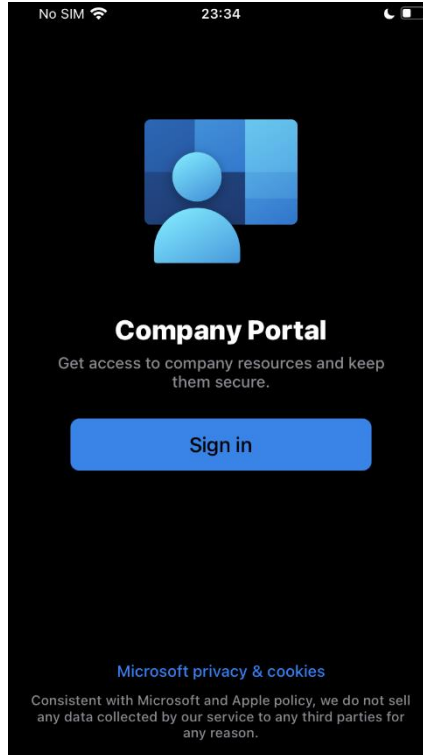

Sign in with your Microsoft 365 account. This is usually the same as your company email address.

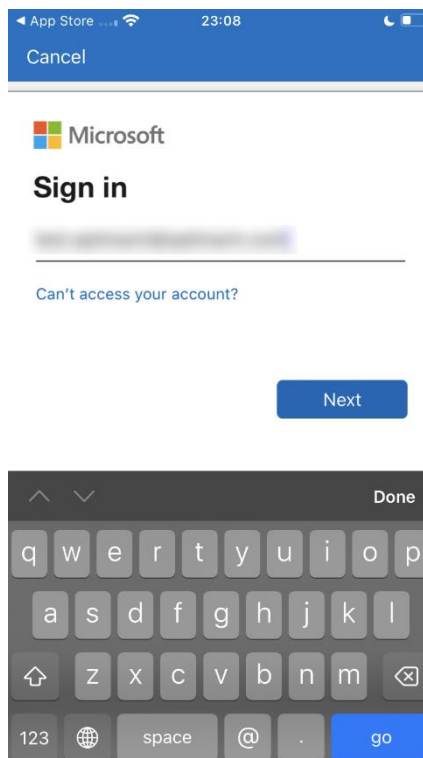

We recommend allowing notifications from the Company Portal app.

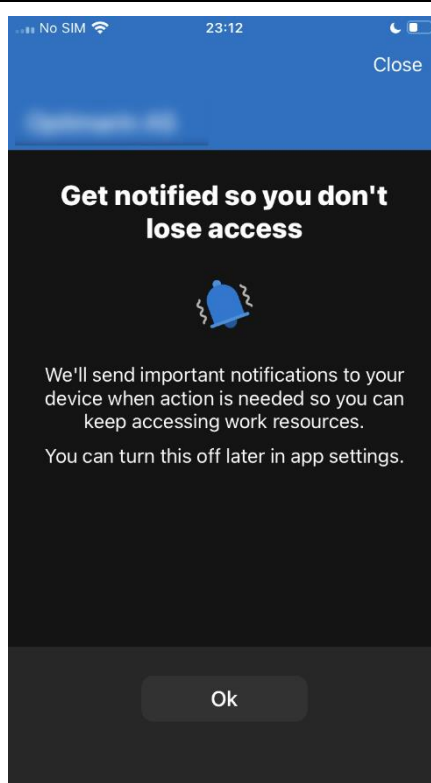

Start the enrollment process by pressing **Begin**

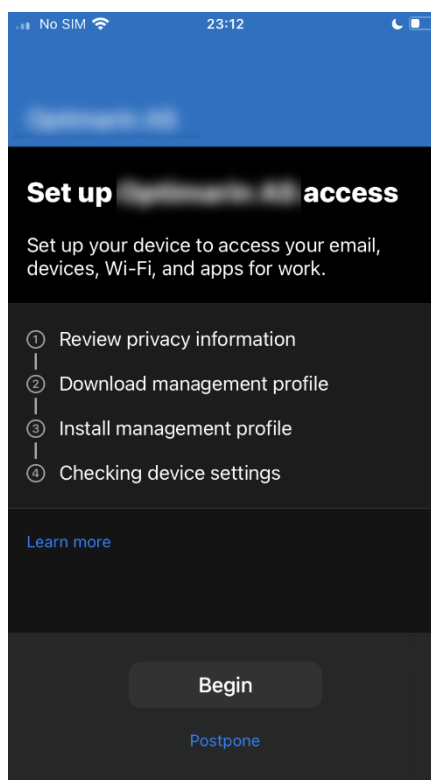

Read the information and press **Continue**

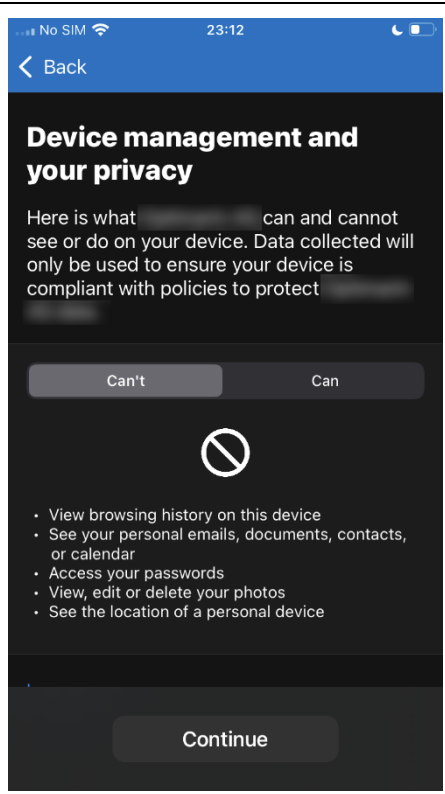

Read the information and press **Continue**

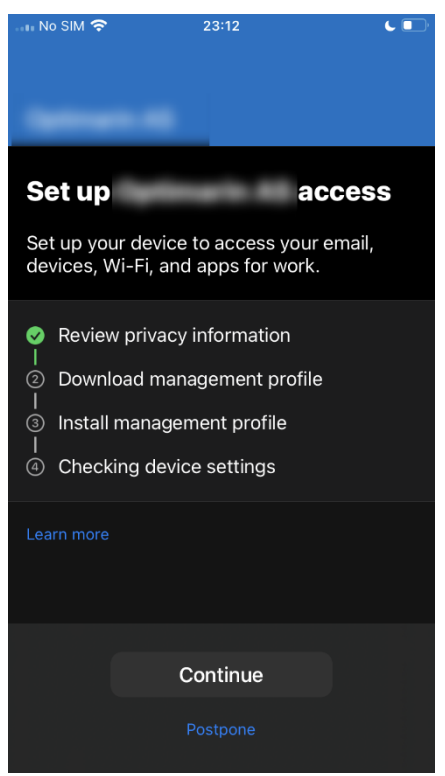

Press **Allow** to continue

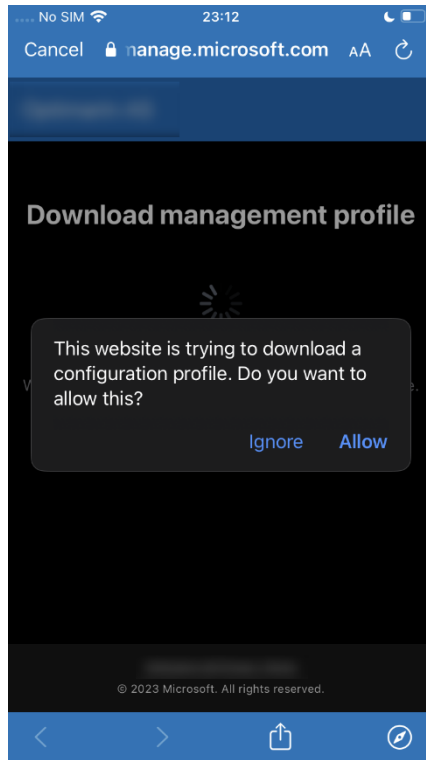

Press **Close** then **Continue**.

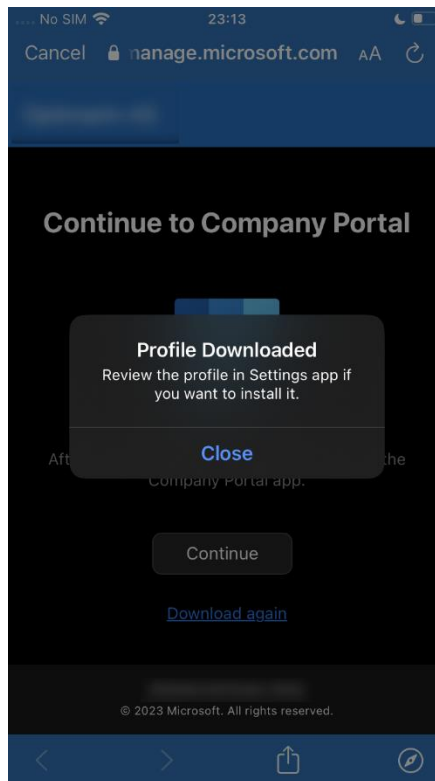

Press **Continue**

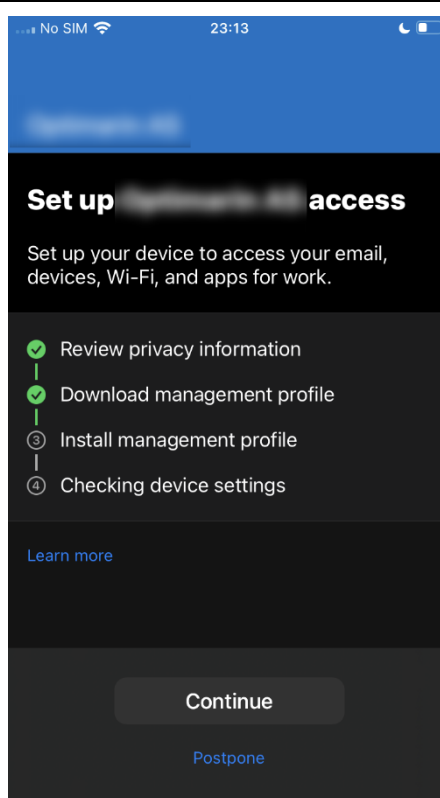

In settings, press **Profile Downloaded**. If you can't see it then Profile Downloaded might be under **More for Your iPhone**.

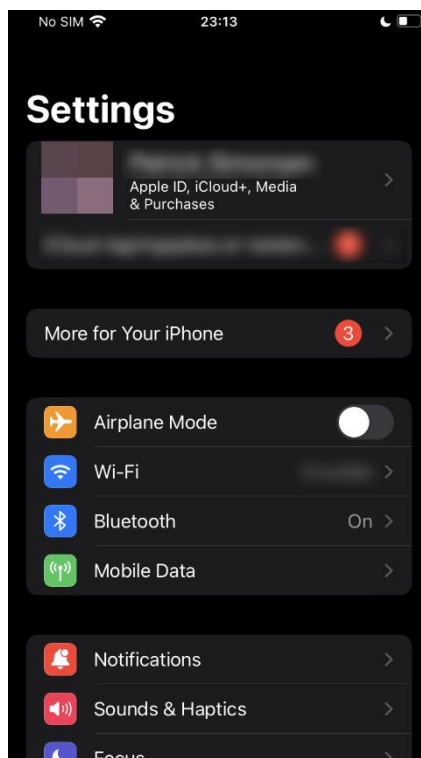

Press **Install** to install management profile

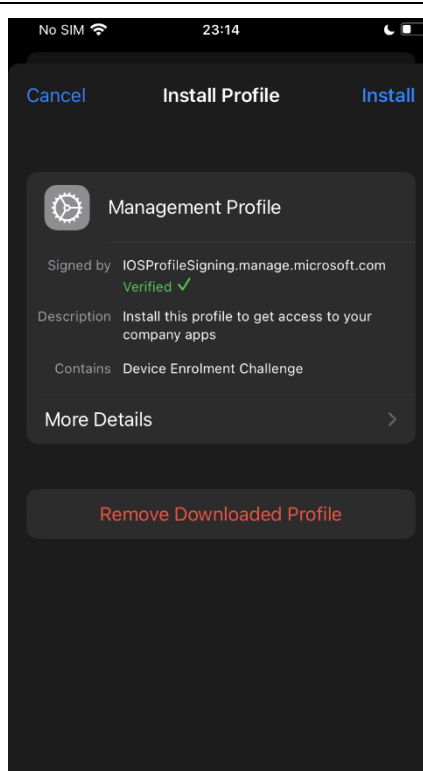

Press **Install** to install management profile

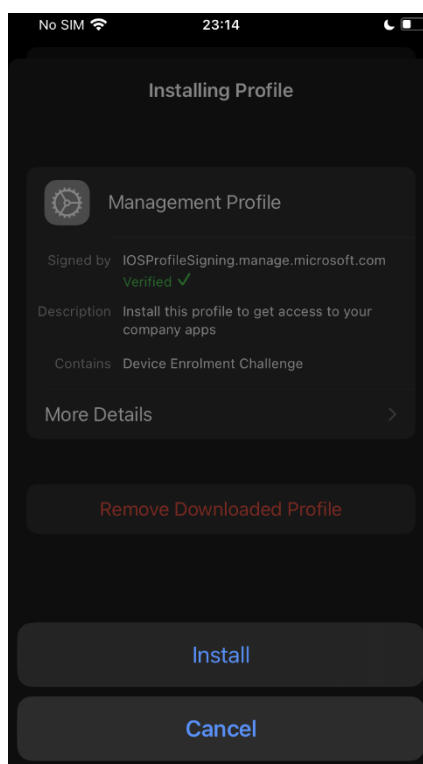

Press **Install** to install Certificates

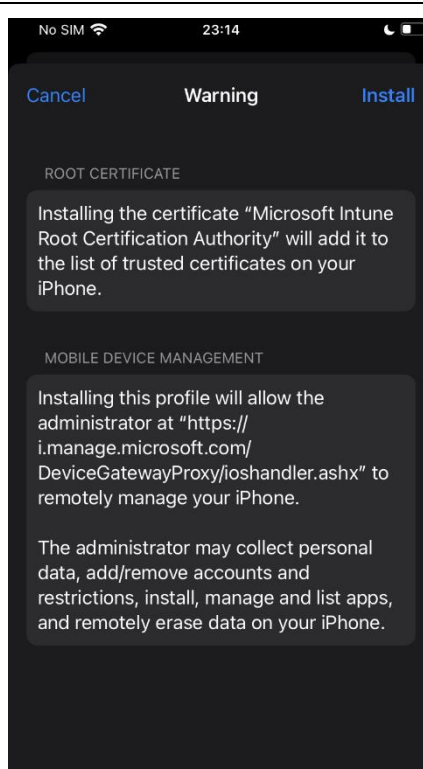

Press **Trust** to enroll your iPhone for remote management

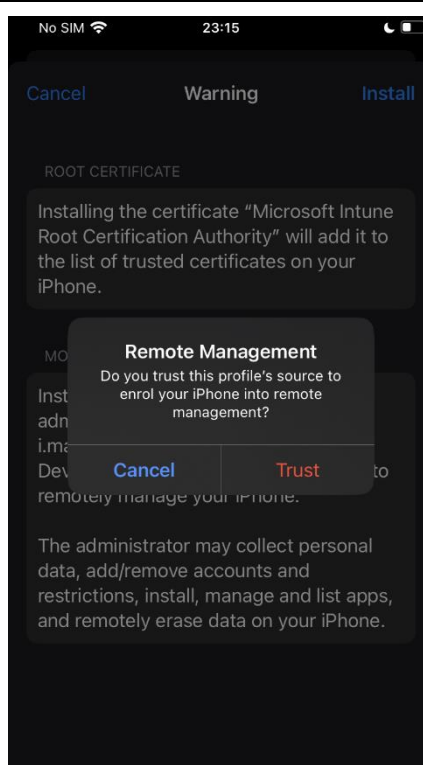

Press **Done** and go back to the Company Portal app again.

Press **Yes, I installed the profile** if it doesn't automatically show this screen with the green checkmark on **Install management profile**.

Press **Continue**.

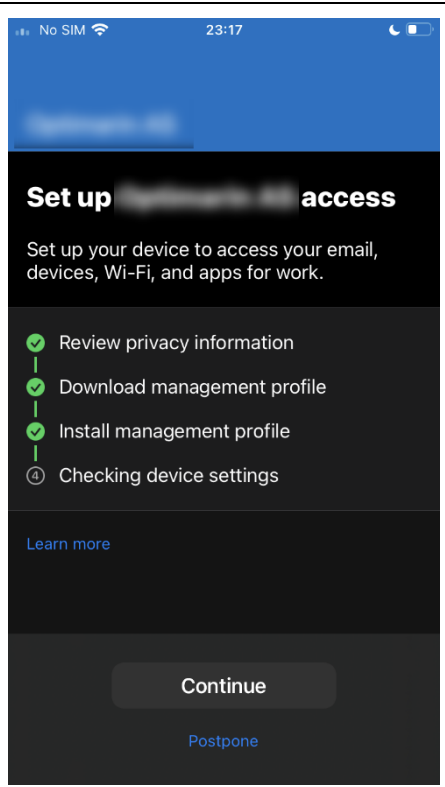

Wait until settings are applied. It can take a few minutes.

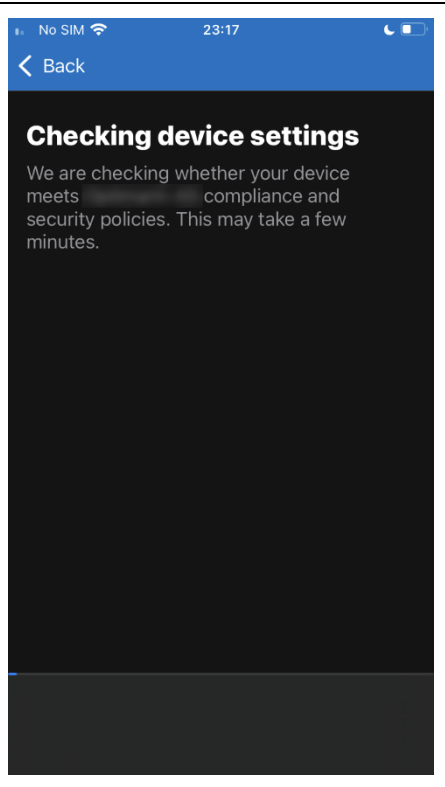

You will now get several prompts for confirming the App installations depending on what has been requested for your organization.

Press **Install**. If you press Cancel it will ask again later.

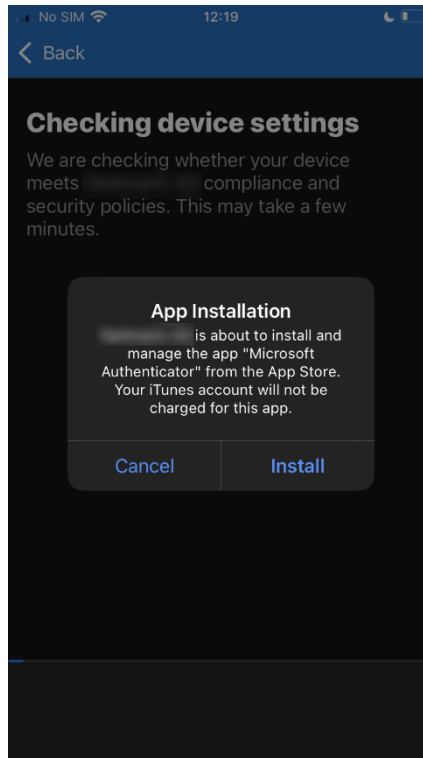

If you already have a required app installed on your device you will be asked to allow the organization to manage it.

Press **Manage**.

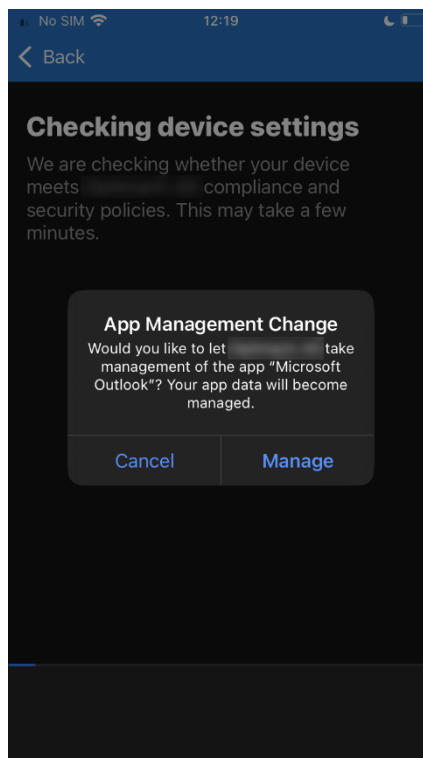

You may be asked to log in with your account details again for other applications such as your Exchange account in Outlook.  
Press **Edit Settings** and log in again.

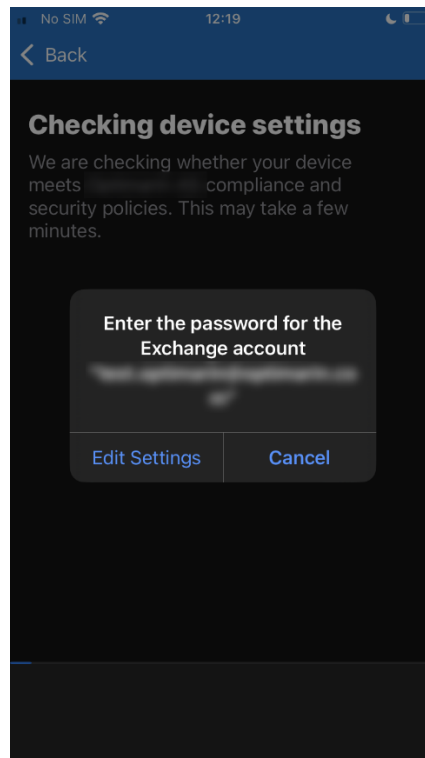

If at the end there are any more settings that need to be changed for access to company resources they will be listed here.  
If you need to **set a device password** see the next step.

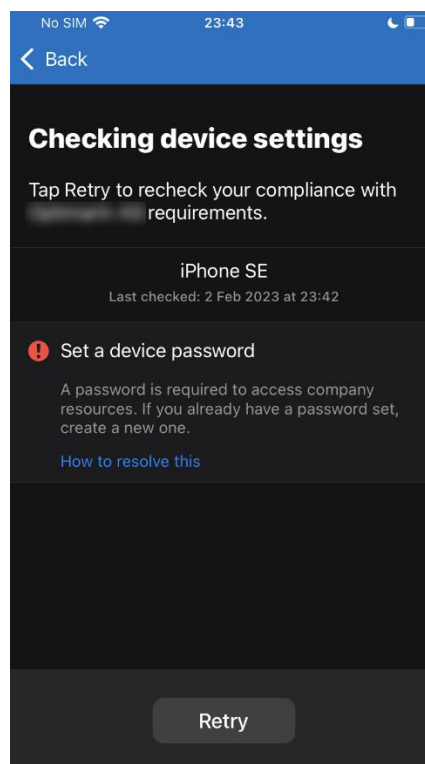

If you're required to update your device password you will have to press the **Home button** to reveal the dialogue box asking you to change it. Press **Change Now**.

Once changed go back to the Company Portal app and press **Retry** to control settings again.

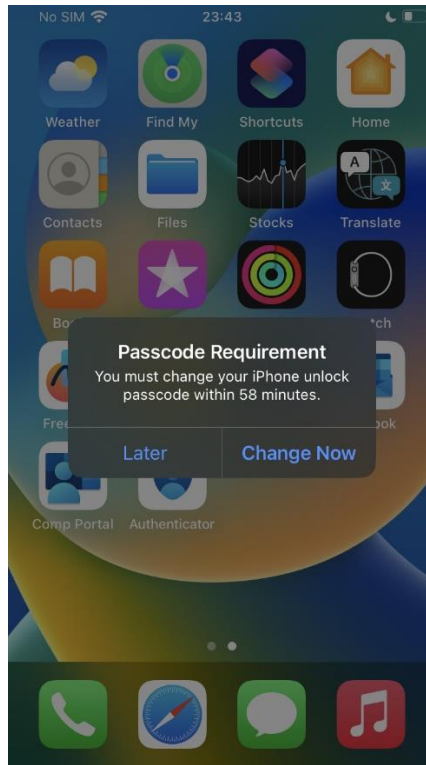

You're all set!  
Press **Done** when finished – Your device is now set up with management via Intune.

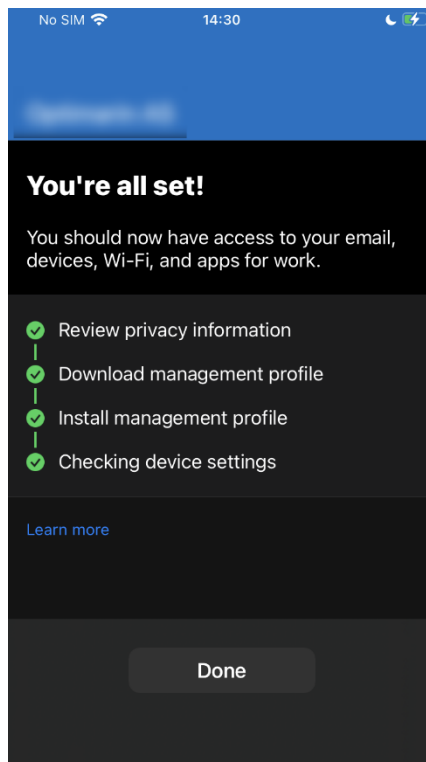

You can now have a look at other apps provided to your company. Launch the Company Portal app and press **View** to see these App's

